

Stab-Plate Wet-Mateable Connector

**Nautilus™ Series
Product Technical Specification –
Electrical Connector**

General

The connector is designed to meet the specification shown in Table 1. Each deliverable connector is Factory Acceptance Tested (FAT) either individually, or as part of an assembly, as specified in Table 2. A Certificate of Conformance (C of C) is supplied with each connector or associated assembly. Upon request, a documentation package including as-built General Arrangement drawing, material traceability log and test results can be provided.

Table 1 – Standard Specifications

Physical Characteristics:

Type: Stab-Plate Operable
 Number of Circuits: 4,7,12 – Others available on request
 Material: 316L SS - Titanium CP Gr2 available on request
 Alignment Key: Single

Fixed Mount Stab-Plate Connector Half –

- Plug or Receptacle Available
- Front Mount Standard – Rear Mount Available on Request

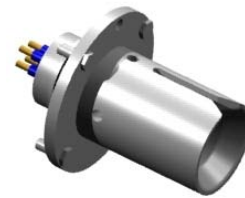

Operational Characteristics:

Amperage Rating: 30 Amps per circuit
 Voltage Rating (per IEC 60502): 1.8 kVac – phase-to-ground
 3.0 kVdc – phase-to-phase
 Mate/Demate Cycles: >1,000
 Operating Depth: Pressure compensated for full ocean depth.
 Consult ODI for pressure differentials >3,000psi
 Operational Temperature: -2°C - +50°C
 Storage Temperature: -25°C - +60°C
 Mating Force: <6 lbs. Force per circuit
 Circuit Resistance: <0.1 Ω (<30 mΩ Typical)
 Contact Resistance: <10 mΩ (Not measurable as an assembly)

Floating Stab-Plate Connector Half –

- Plug or Receptacle Available
- Rear Mount Configuration
- Straight Termination Required

Design Characteristics:

Design Life: 25 Years

Table 2 – FAT Standards

Hydrostatic Test:-
 Minimum Differential Pressure 3,000 psi
 Insulation Resistance Pin-Ground >10 GΩ @ 1,000Vdc
 Post Hydrostatic Bench Tests:-
 Circuit Resistance <0.1 Ω
 Insulation Resistance Pin-Ground >10 GΩ @ 1,000Vdc
 Mateability Function 1 Cycle Minimum with latch verification

